

TYPE A1

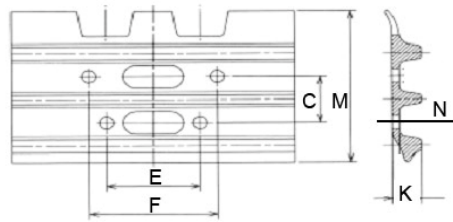

TYPE A2

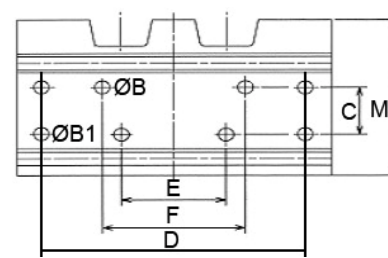

TYPE B1

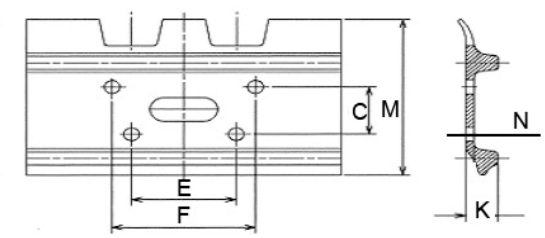

TYPE B2

No.	MACHINE MODEL	TYPE	CATERPILLA PART No.	KOMATSU PART No.	HITACHI PART No.	PART No.	DIMENSION (mm)										L	
							PITCH	B	B1	C	E	F	D	K	M	N		
1	SK030.IHI30J,EX35,EX30	B2				W101A-6.5-300	101.00	Ø10.5		22.00	55.00	55.00		22.50	110.00	6.50	300.00	
2	SK030.IHI30J,EX35,PC30	B2				W101B-6.5-300	101.00							22.50	110.00	6.50	300.00	
3	SK030.IHI30J,EX35	B2				W101C-6.5-300	101.00		Ø14				200.00	22.50	110.00	6.50	300.00	
4	EC55,S50	A1				W135A-06-400	135.00	Ø13.5	Ø14	43.40	72.00	99.00	300.00	19.50	152.00	6.00	400.00	
		A2				W135A-06-380	135.00	Ø13.5		43.40	72.00	99.00	300.00	19.50	152.00	6.00	380.00	
5	R500	A1				W135B-06-400	135.00	Ø13.5	Ø14	46.00	80.00	104.00	300.00	19.50	152.00	6.00	400.00	
6	EX40,CAT305T	A1				W135C-06-400	135.00	Ø12.5	Ø14	46.00	80.00	104.00	300.00	19.50	152.00	6.00	400.00	
7	PC60-1/2/3/5,PC60-D,PC60-L,PC60-U, K903-A/B/C,S50,D20,ZY65	A2				W135D-06-260	135.00	Ø12.5		43.00	72.00	99.00		19.50	152.00	6.00	260.00	
		A2				W135D-06-340	135.00	Ø12.5		43.00	72.00	99.00		19.50	152.00	6.00	340.00	
		A2				W135D-06-400	135.00	Ø12.5		43.00	72.00	99.00		19.50	152.00	6.00	400.00	
		A2				W135D-06-450	135.00	Ø12.5		43.00	72.00	99.00		19.50	152.00	6.00	450.00	
		A2		201-32-15111			W135D-06-480	135.00	Ø12.5		43.00	72.00	99.00		19.50	152.00	6.00	480.00
		A2					W135D-06-500	135.00	Ø12.5		43.00	72.00	99.00		19.50	152.00	6.00	500.00
8	307-B/2FL/2PM/2WM/9ZL, E70, E70B, CAT307-E70	A2				W135E-06-400	135.00	Ø13.2		47.00	76.00	106.00		19.50	152.00	6.00	400.00	
		A2				W135E-06-450	135.00	Ø13.2		47.00	76.00	106.00		19.50	152.00	6.00	450.00	
		A2				W135E-06-500	135.00	Ø13.2		47.00	76.00	106.00		19.50	152.00	6.00	500.00	
		A2				W135E-06-600	135.00	Ø13.2		47.00	76.00	106.00		19.50	152.00	6.00	600.00	
9	PC40-7,PC45,PC50-7/8,SK40	A2				W135F-06-400	135.00	Ø12.3		47.00	64.00	94.00		19.50	152.00	6.00	400.00	
10	YC35-6/7,SWE55 U45,KH25,KX15	A2				W135H-06-400	135.00	Ø12.5		52.00	86.00	86.00		20.00	152.00	6.00	400.00	
		A2				W135H-06-500	135.00	Ø12.5		46.00	74.40	98.40		14.00	152.00	6.00	500.00	
11	FL4					W140A-09-400	140.00	Ø12.3		52.00	86.00	86.00		27.00	163.00	9.00	400.00	
12	EX60-1/5,CX75-SR,CX80,PC60-6/7, PC60L-6,PC70-6,PC75-UU,PC78-US, PC78-MR, E70, E80 PC88-MR,307-B/C,308-C, SK60, SK70, SK75, SK80, SK95, EX75, EX80-5,JZ70 ZX70,ZX75,ZX80,ZX85	A2		201-35-51130		W154A-06-600	154.00	Ø14.5	Ø16	57.00	73.00	89.00	350.00	26.00	168.00	6.00	600.00	
		A2		201-32-71110	2040402	W154A-06-450	154.00	Ø14.5	Ø16	57.00	73.00	89.00	350.00	26.00	168.00	6.00	450.00	
		A2		201-32-51340		W154A-06-700	154.00	Ø14.5	Ø16	57.00	73.00	89.00	350.00	26.00	168.00	6.00	700.00	

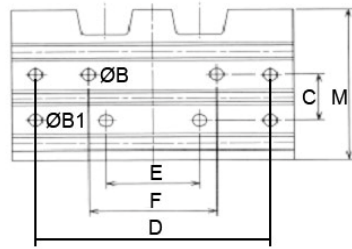

TYPE A1

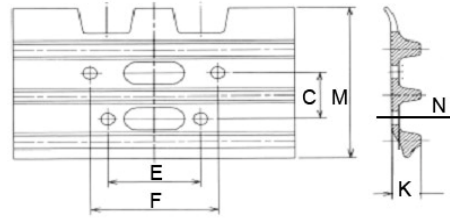

TYPE A2

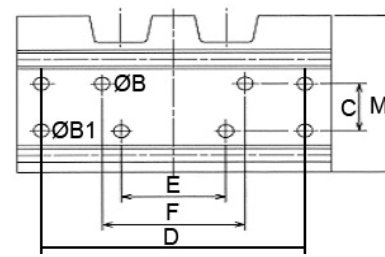

TYPE B1

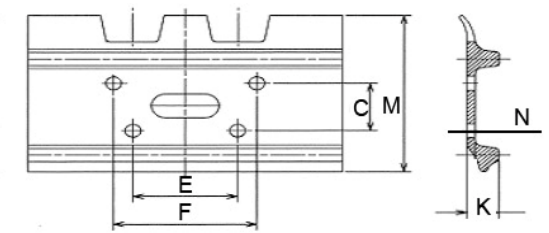

TYPE B2

No.	MACHINE MODEL	TYPE	CATERPILLA PART No.	KOMATSU PART No.	HITACHI PART No.	PART No.	DIMENSION (mm)										L
							PITCH	B	B1	C	E	F	D	K	M	N	
13	PC100-1/2/3/5/6	A1				W154B-06-450	154.00	Ø14.5	Ø16	57.00	82.40	112.40	350.00	26.00	168.00	6.00	450.00
	PC120-1/2/3,PC80-1/3,PC80LC-3	A2		202-32-11112		W154B-06-480	154.00	Ø14.5		57.00	82.40	112.40		26.00	168.00	6.00	480.00
		A2		203-32-41110		W154B-06-510	154.00	Ø14.5		57.00	82.40	112.40		26.00	168.00	6.00	510.00
		A2		202-32-11280		W154B-06-610	154.00	Ø14.5		57.00	82.40	112.40		26.00	168.00	6.00	610.00
14	EX60-1/2/3, EX75U, EX90,ECR88	A1				W154C-06-450	154.00	Ø14.5	Ø16	55.00	90.00	90.00	350.00	26.00	168.00	6.00	450.00
	EC60LC-3	A2			2030531	W154C-06-450	154.00	Ø14.5		55.00	90.00	90.00		26.00	168.00	6.00	450.00
15	CAT312,E120,DH120,EX100-1/2/3/5, EX120-1/2/3/5,205-3HC1,211-5CC/LC/B, 225-51U/76U,312BL	A1				W171A-08-500	171.00	Ø16.3	Ø18	60.40	108.00	108.00	400.00	26.00	188.00	8.00	500.00
	213-9XB-LC-B,215-14Z/57Y/95Z/LC, 215-B/C/D,311-B/C5PK/9LJ,313-B, 314-C, K905, E145,211B	A2	5W9830		2019235	W171A-08-510	171.00	Ø16.3		60.40	108.00	108.00		26.00	188.00	8.00	510.00
	312-B/C/6BL/6GK/BL,933-E/G, 941-B/16U/70H/75H/80H,943-03Y/31Y/LGP, EX135, K904,H9-B	A2	931939			W171A-08-600	171.00	Ø16.3		60.40	108.00	108.00		26.00	188.00	8.00	600.00
	E110, E120-B, E140, SK100, SK115, SK120, SK130, SK135, E115,	A2				W171A-08-700	171.00	Ø16.3		60.40	108.00	108.00		26.00	188.00	8.00	700.00
	EX110-5, EX130, ZX110, ZX120, ZX130, ZX135,R130,R140,UH061, UH062,UH063,H5,H7-B/C	A2				W171A-08-800	171.00	Ø16.3		60.40	108.00	108.00		26.00	188.00	8.00	800.00
	UH03, UH035-7, UH04-1/2/3/5/7, UH041, UH042, UH043, UH045-3/5/7, UH051, UH053	A2				W171A-08-900	171.00	Ø16.3		60.40	108.00	108.00		26.00	188.00	8.00	900.00
	JCB817,JCB818,JS110,JS115,JS130,JS145, EC130,EC140,EC150,EC160,EC200,ECR145	A2				W171A-9.5-600	171.00	Ø18.5		57.00	122.40	158.40		25.00	198.80	9.50	600.00
16	EX100M-1/2/3, EX150,EX150LC	A2				W171B-08-500	171.00	Ø16.5		58.70	110.90	130.00		26.00	188.00	8.00	500.00
		A2				W171B-08-700	171.00	Ø16.5		58.70	110.90	130.00		26.00	188.00	8.00	700.00
		A2				W171B-08-760	171.00	Ø16.5		58.70	110.90	130.00		26.00	188.00	8.00	760.00
17	215,215LC-14Z	A2	3T3648			W171C-08-500	171.00	Ø16.2		60.40	92.00	92.00		26.00	188.00	8.00	500.00
18	PC150-1/3,PC100-L,PC150-LC	A2				W175A-08-500	175.00	Ø18.5		57.00	122.40	158.40		33.00	198.00	8.00	500.00
	DH880	A2				W175A-08-600	175.00	Ø18.5		57.00	122.40	158.40		33.00	198.00	8.00	600.00

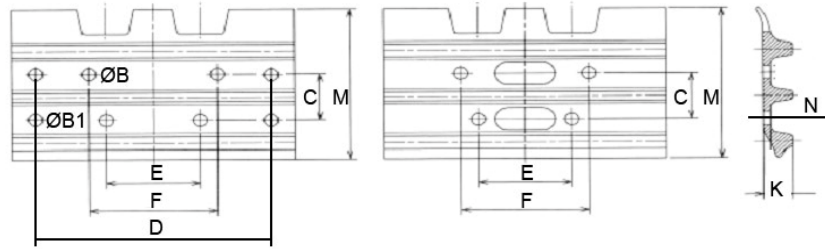

TYPE A1

TYPE A2

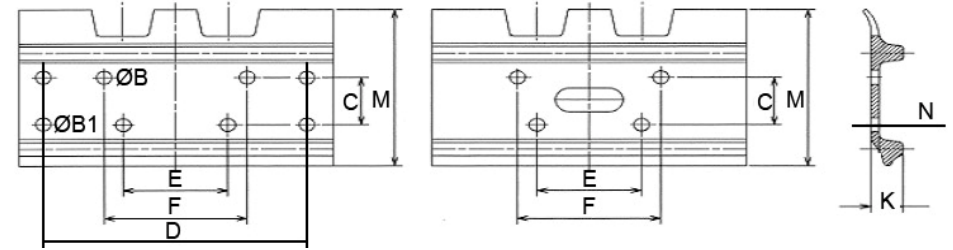

TYPE B1

TYPE B2

No.	MACHINE MODEL	TYPE	CATERPILLA			KOMATSU			HITACHI			PART No.	DIMENSION (mm)							L		
			PART No.	PART No.	PART No.	PART No.	PART No.	PART No.	PITCH	B	B1		C	E	F	D	K	M	N			
19	E180, EL180, K907B, EX200-1, UH06-5, UH07-3/5/7, UH071, UH081, UH082, UH083	A2									W175B-08-500	175.00	Ø18.5		58.70	125.40	144.50		33.00	198.00	8.00	500.00
	UH09-2, UH101, JS150, JS200, EX200-1, EX200LC-1, DH220LC	A2									W175B-08-600	175.00	Ø18.5		58.70	125.40	144.50		33.00	198.00	8.00	600.00
	UH07LC-5/7, UH081LC, UH082LC, UH083LC	A2									W175B-08-700	175.00	Ø18.5		58.70	125.40	144.50		33.00	198.00	8.00	700.00
		A2									W175B-08-800	175.00	Ø18.5		58.70	125.40	144.50		33.00	198.00	8.00	800.00
		A2									W175B-08-900	175.00	Ø18.5		58.70	125.40	144.50		33.00	198.00	8.00	900.00
		A2									W175-11.5-660	175.00	Ø17.0		57.00	103.80	143.80		33.00	199.00	11.50	660.00
20	FH200	A2									W175D-08-355	175.00	Ø18.5		60.00	116.00	138.00		33.00	198.00	8.00	355.00
		A2									W175D-08-500	175.00	Ø18.5		60.00	116.00	138.00		33.00	198.00	8.00	500.00
		A2									W175D-08-600	175.00	Ø18.5		60.00	116.00	138.00		33.00	198.00	8.00	600.00
21	FL10	A2									W175E-08-380	175.00	Ø16.5		60.00	115.00	138.00		33.00	198.00	8.00	380.00
22	115-C, 115-CK, 155-CL, 125-CK, 160-CK, 90-BCK, 980-B, GC120, LC80, LC80-M, 977-D, UH04	A2									W175F-08-355	175.00	Ø16.5		58.70	125.40	144.50		33.00	198.00	8.00	355.00
	MC100, MC100-L, SC150, SC150L, TC45, TCS, 215-B, 225-51U/61X/76U/LC/B, UH052, LR621	A2									W175F-08-400	175.00	Ø16.5		58.70	125.40	144.50		33.00	198.00	8.00	400.00
	561-B/C/D, 951-B/C, 953B/C/76Y/77Y/78Y/LGP, 955-C/H/K/L, K907-A/B/C, LR622	A2									W175F-08-500	175.00	Ø16.5		58.70	125.40	144.50		33.00	198.00	8.00	500.00
	K907-D, R130, R140, R160, R180, R200, R210-3, H10-1/B, H11-1/B, H12-1/B	A2	3V9489								W175F-08-560	175.00	Ø16.5		58.70	125.40	144.50		33.00	198.00	8.00	560.00
	JCB7-C, JCB8-C, JCB-HD, JCB807, JCB808, JCB820, JCB822	A2									W175F-08-600	175.00	Ø16.5		58.70	125.40	144.50		33.00	198.00	8.00	600.00
	DL211, 215SA	A2									W175F-08-700	175.00	Ø16.5		58.70	125.40	144.50		33.00	198.00	8.00	700.00
	PCAT951/955	A2									W175F-08-800	175.00	Ø16.5		58.70	125.40	144.50		33.00	198.00	8.00	800.00
	DL221	A2									W175F-08-900	175.00	Ø16.5		58.70	125.40	144.50		33.00	198.00	8.00	900.00
23	PC100-5/6, PC120-5/6, PC110-R, PC128, PC130-5/6/7, PC138, PC90-1	A1									W175G-08-500	175.00	Ø16.5	Ø18	57.00	86.40	102.40	400.00	33.00	198.00	8.00	500.00
		A2		203-32-52110							W175G-08-500	175.00	Ø16.5		57.00	86.40	102.40		33.00	198.00	8.00	500.00
	PC128UU-1	A2									W175G-08-600	175.00	Ø16.5		57.00	86.40	102.40		33.00	198.00	8.00	600.00
		A2									W175G-08-700	175.00	Ø16.5		57.00	86.40	102.40		33.00	198.00	8.00	700.00
	PC90-1	A2									W175G-08-480	175.00	Ø16.5		57.00	86.40	102.40		33.00	198.00	8.00	480.00

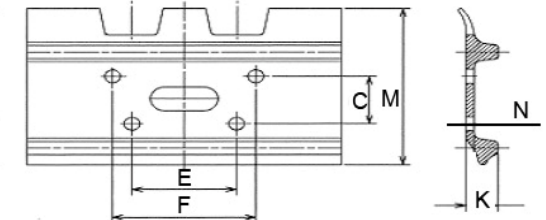
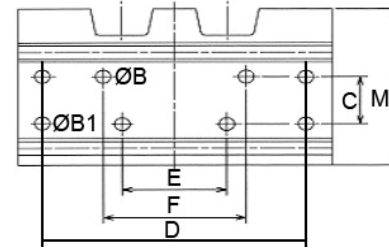
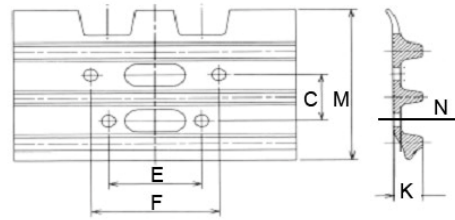
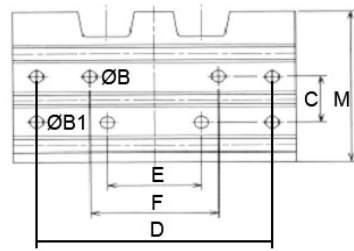

TYPE A1

TYPE A2

TYPE B1

TYPE B2

No.	MACHINE MODEL	TYPE				PART No.	DIMENSION (mm)										L
			CATERPILLA PART No.	KOMATSU PART No.	HITACHI PART No.		PITCH	B	B1	C	E	F	D	K	M	N	
24	PC150LC-3	A2		130-32-11420		W175H-08-460	175.00	Ø16.2		57.00	122.40	158.40		33.00	198.00	8.00	460.00
	PC150-1/3,PC150LC-1	A2		21K-32-11110		W175H-08-510	175.00	Ø16.2		57.00	122.40	158.40		33.00	198.00	8.00	510.00
	PC100L-1/2/3,DH770,DH800	A2		204-32-11110		W175H-08-760	175.00	Ø16.2		57.00	122.40	158.40		33.00	198.00	8.00	760.00
25	EX200-2/5/6,EX210,EX220	A2				W190A-8.5-500	190.00	Ø18.5		62.00	124.40	160.40		34.50	219.00	8.50	500.00
	E300,EL240	A2	931948		2027982	W190A-8.5-600	190.00	Ø18.5		62.00	124.40	160.40		34.50	219.00	8.50	600.00
	PC180,PC200-1/3/5,PC220	A2		205-32-51271		W190A-8.5-610	190.00	Ø18.5		62.00	124.40	160.40		34.50	219.00	8.50	610.00
		A2		206-32-41110	2038824	W190A-8.5-700	190.00	Ø18.5		62.00	124.40	160.40		34.50	219.00	8.50	700.00
		A2				W190A-8.5-800	190.00	Ø18.5		62.00	124.40	160.40		34.50	219.00	8.50	800.00
26	PC200-5/6,R220	A2		20Y-32-11361		W190B-8.5-500	190.00	Ø20.5		62.00	124.40	160.40		34.50	219.00	8.50	500.00
	EX200-2/3,EX220LC-2/3 PC100L-5/6	A2		20Y-32-11111	2030005	W190B-8.5-600	190.00	Ø20.5		62.00	124.40	160.40		34.50	219.00	8.50	600.00
		A2		20Y-32-11311		W190B-8.5-700	190.00	Ø20.5		62.00	124.40	160.40		34.50	219.00	8.50	700.00
		A2		20Y-32-11321		W190B-8.5-800	190.00	Ø20.5		62.00	124.40	160.40		34.50	219.00	8.50	800.00
		A2				W190B-8.5-900	190.00	Ø20.5		62.00	124.40	160.40		34.50	219.00	8.50	900.00
27	LR624	A2				W190C-13.5-560	190.00	Ø20.4		68.00	120.80	166.80		55.50	222.00	13.50	560.00
	LR624	A2				W190C-13.5-610	190.00	Ø21.0		57.00	128.20	168.20		55.50	222.00	13.50	610.00
	E200B,E240,315	A2	993490			W190C-8.5-500	190.00	Ø20.5		69.00	119.60	155.60		34.50	219.00	8.50	500.00
	SK200	A2				W190C-8.5-560	190.00	Ø20.5		69.00	119.60	155.60		34.50	219.00	8.50	560.00
	217,320,322,318 322BL,322BLN,322L	A2	967576 964311			W190C-8.5-600 W190C-8.5-800	190.00 190.00	Ø20.5 Ø20.5		69.00 69.00	119.60 119.60	155.60 155.60		34.50 34.50	219.00 219.00	8.50 8.50	600.00 800.00
28	215BSA,219,219D,219DLC,219LC	A2				W190D-8.5-500	190.00	Ø19.5		69.00	119.60	155.60		34.50	219.00	8.50	500.00
	225B,225BLC,225D,225DLC	A2	9W6728			W190D-8.5-560	190.00	Ø19.5		69.00	119.60	155.60		34.50	219.00	8.50	560.00
		A2				W190D-8.5-600	190.00	Ø19.5		69.00	119.60	155.60		34.50	219.00	8.50	600.00
29	125-CKB,PC180-3,PC200-1/2/3,PC200-LC, PC220-1/2/3,PC220-LC,PF55-L, K909, EX100	A2				W190A-10-500	190.00	Ø18.5		62.00	124.40	160.40		36.00	219.00	10.00	500.00
	K909A, EX165, EX215, EX150, EX160, EX200-2/3/5/6, EX210, UH103, ZX110 EC140,EC160,EC180,EC229,EC300,H10-B, H12-B,EX220	A2	931048		2027982	W190A-10-600	190.00	Ø18.5		62.00	124.40	160.40		36.00	219.00	10.00	600.00
		A2		205-32-51271		W190A-10-610	190.00	Ø18.5		62.00	124.40	160.40		36.00	219.00	10.00	610.00
		A2		206-32-41110	2038824	W190A-10-700	190.00	Ø18.5		62.00	124.40	160.40		36.00	219.00	10.00	700.00
		A2				W190A-10-800	190.00	Ø18.5		62.00	124.40	160.40		36.00	219.00	10.00	800.00
A2				W190A-10-900	190.00	Ø18.5		62.00	124.40	160.40		36.00	219.00	10.00	900.00		

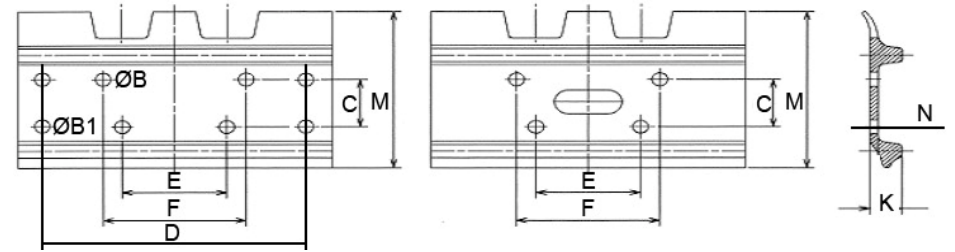
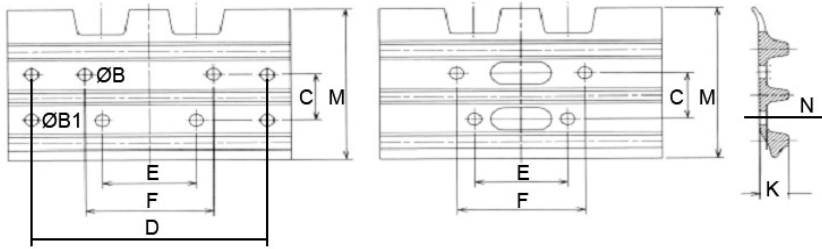

TYPE A1

TYPE A2

TYPE B1

TYPE B2

No.	MACHINE MODEL	TYPE				PART No.	DIMENSION (mm)										L
			CATERPILLA PART No.	KOMATSU PART No.	HITACHI PART No.		PITCH	B	B1	C	E	F	D	K	M	N	
30	PC200-3/5/6/7/8, EX220-1/2/3/5,DH220,PC230,PC100-L, PC150-5,PC150-HD,PC158, E300	A2		20Y-32-11361		W190B-10-500	190.00	Ø20.5		62.00	124.40	160.40		36.00	219.00	10.00	500.00
	PC160-6,PC180-LC,PC180-LLC, PC180-NLC,PC200-5/6,PC210-3/5/6, PC210-7K/8K, EX230	A2		20Y-32-11111	2030005	W190B-10-600	190.00	Ø20.5		62.00	124.40	160.40		36.00	219.00	10.00	600.00
	PC210-NLC,PC220-3/5/6/7,PC220-LC, PC280-UU,PC230-6,PC230-LC, PF55-L,EC210,EC230	A2		20Y-32-11311		W190B-10-700	190.00	Ø20.5		62.00	124.40	160.40		36.00	219.00	10.00	700.00
	PC240-3K/5K/6K/7K,PC240-LC,PC240-NLC, EL240, K909, K909A, EX225,EC240,ZX160	A2		20Y-32-11321		W190B-10-800	190.00	Ø20.5		62.00	124.40	160.40		36.00	219.00	10.00	800.00
	R200-3,R210,R250,ZX180,ZX200-3, ZX210-3,ZX225,ZX230-3,ZX240,ZX250, EX200-2/3,EX220LC-2/3	A2				W190B-10-900	190.00	Ø20.5		62.00	124.40	160.40		36.00	219.00	10.00	900.00
31	CX160,CX160-B,CX180,CX180-B, CX210,CX225-SR,CX230,CX240, 215-B,E200B, E135, E175,322BLN	A2	993490			W190C-10-500	190.00	Ø21		69.00	119.60	155.60		36.00	219.00	10.00	500.00
	219-5CF/LC/D,E240,225-B/D,315-L/B/C,317-B/N, 318-B/C,319-C, E240-B/C, ED150, E195, E265	A2				W190C-10-560	190.00	Ø21		69.00	119.60	155.60		36.00	219.00	10.00	560.00
	320,CAT320,320-B/C/D,321-B/C,322/B/C, 323-D,324-D, E200-B, SK235, SK250, E200, E215,322L	A2	967576			W190C-10-600	190.00	Ø21		69.00	119.60	155.60		36.00	219.00	10.00	600.00
	EL200-B, EL240-B/C, SK150, SK160, SK170, SK200, SK210, SK220, E115,	A2	964311			W190C-10-800	190.00	Ø21		69.00	119.60	155.60		36.00	219.00	10.00	800.00
32	215BSA,219,219D,219DLC,219LC	A2				W190D-10-500	190.00	Ø19.5		69.00	119.60	155.60		36.00	219.00	10.00	500.00
	225B,225BLC,225D,225DLC	A2	9W6728			W190D-10-560	190.00	Ø19.5		69.00	119.60	155.60		36.00	219.00	10.00	560.00
		A2				W190D-10-600	190.00	Ø19.5		69.00	119.60	155.60		36.00	219.00	10.00	600.00
		A2				W190D-10-700	190.00	Ø19.5		69.00	119.60	155.60		36.00	219.00	10.00	700.00
33	PC250-6,PC250LC,PC280-NLC, PC300-1/2/3/5,PC300NLC-3, E300-B, EL300-B, EX270-2/5	A2		207-32-A1110		W203A-11-600	203.00	Ø20.5		72.10	138.40	178.40		39.00	236.00	11.00	600.00
	K910, K912-A, EX300-1/2/3, EX310, UH10-2, UH12-1/2/7, UH121, UH122, UH123	A2		207-32-11163		W203A-11-610	203.00	Ø20.5		72.10	138.40	178.40		39.00	236.00	11.00	610.00
	UH143,R250,R280,R290,R320,JS240,JS260, JS300	A2		207-32-A1310		W203A-11-700	203.00	Ø20.5		72.10	138.40	178.40		39.00	236.00	11.00	700.00
	PC300-1/3/5	A2		207-32-A1350		W203A-11-800	203.00	Ø20.5		72.10	138.40	178.40		39.00	236.00	11.00	800.00
	PC300LC-3/5,PC250LC-6	A2		207-32-11411		W203A-11-900	203.00	Ø20.5		72.10	138.40	178.40		39.00	236.00	11.00	900.00

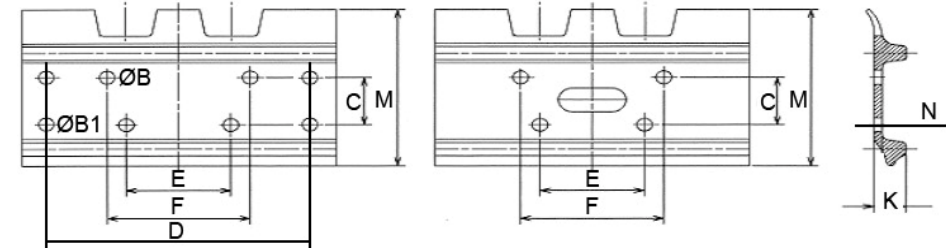
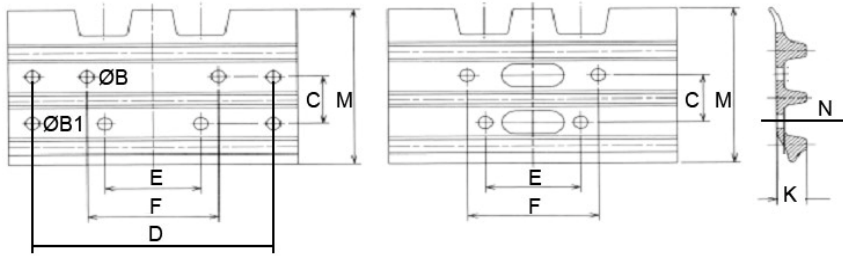

TYPE A1

TYPE A2

TYPE B1

TYPE B2

No.	MACHINE MODEL	TYPE				PART No.	DIMENSION (mm)										L
			CATERPILLA PART No.	KOMATSU PART No.	HITACHI PART No.		PITCH	B	B1	C	E	F	D	K	M	N	
34	E325ST	A2				W203B-11-500	203.00	Ø21.0		72.10	129.00	179.00		39.00	236.00	11.00	500.00
	CAT325	A2				W203B-11-600	203.00	Ø21.0		72.10	129.00	179.00		39.00	236.00	11.00	600.00
	E325ST	A2				W203B-11-700	203.00	Ø21.0		72.10	129.00	179.00		39.00	236.00	11.00	700.00
	325	A2				W203B-11-800	203.00	Ø21.0		72.10	129.00	179.00		39.00	236.00	11.00	800.00
35	FH300/330(HY)R450	A2				W203C-11-500	203.00	Ø20.5		76.20	146.05	184.15		39.00	236.00	11.00	500.00
		A2				W203C-11-600	203.00	Ø20.5		76.20	146.05	184.15		39.00	236.00	11.00	600.00
36	E300,EL240	A2	931948			W203D-11-600	203.00	Ø19.5		76.20	133.40	171.50		39.00	236.00	11.00	600
	229,229D	A2	9K3564			W203D-11-610	203.00	Ø19.5		76.20	133.40	171.50		39.00	236.00	11.00	610
	235LC,225SA,227,235	A2	9K3565			W203D-11-710	203.00	Ø19.5		76.20	133.40	171.50		39.00	236.00	11.00	710
	231DLC	A2	9K3568			W203D-11-915	203.00	Ø19.5		76.20	133.40	171.50		39.00	236.00	11.00	915
	231D	A2	1V0557			W203D-11-813	203.00	Ø19.5		76.20	133.40	171.50		39.00	236.00	11.00	813
37	RH9	A2				W203E-11-500	203.00	Ø19.5		76.20	116.90	155.00		39.00	236.00	11.00	500.00
		A2				W203E-11-600	203.00	Ø19.5		76.20	116.90	155.00		39.00	236.00	11.00	600.00
38	CAT977K	A2				W203F-11-500	203.00	Ø19.5		76.20	146.05	184.15		39.00	236.00	11.00	500.00
		A2				W203F-11-600	203.00	Ø19.5		76.20	146.05	184.15		39.00	236.00	11.00	600.00
		A2				W203F-11-700	203.00	Ø19.5		76.20	146.05	184.15		39.00	236.00	11.00	700.00
		A2				W203F-11-800	203.00	Ø19.5		76.20	146.05	184.15		39.00	236.00	11.00	800.00
		A2				W203F-11-900	203.00	Ø19.5		76.20	146.05	184.15		39.00	236.00	11.00	900.00
39	R944	A2				W203G-11-600	203.00	Ø19.5		76.20	148.20	186.20		39.00	236.00	11.00	600.00
40	EC290-B/C,PC300-1/3,EX300-3	A2		207-32-A1110		W203A-13-600	203.00	Ø20.5		72.10	138.40	178.40		41.00	236.00	13.00	600.00
	PC300NLC-3	A2		207-32-11163		W203A-13-610	203.00	Ø20.5		72.10	138.40	178.40		41.00	236.00	13.00	610.00
	PC250LC-6,PC300LC-3/5,PC300-5	A2		207-32-A1310		W203A-13-700	203.00	Ø20.5		72.10	138.40	178.40		41.00	236.00	13.00	700.00
	EX270,EX300-1/2/3	A2		207-32-A1350		W203A-13-800	203.00	Ø20.5		72.10	138.40	178.40		41.00	236.00	13.00	800.00
	PC300-5,PC300LC-1/2	A2		207-32-11411		W203A-13-900	203.00	Ø20.5		72.10	138.40	178.40		41.00	236.00	13.00	900.00
41	E325ST	A2				W203B-13-500	203.00	Ø21.0		72.10	129.00	179.00		41.00	236.00	13.00	500.00
	CAT325	A2				W203B-13-600	203.00	Ø21.0		72.10	129.00	179.00		41.00	236.00	13.00	600.00
	E325ST	A2				W203B-13-700	203.00	Ø21.0		72.10	129.00	179.00		41.00	236.00	13.00	700.00
	325	A2				W203B-13-800	203.00	Ø21.0		72.10	129.00	179.00		41.00	236.00	13.00	800.00
42	FH300/330(HY)450	A2				W203C-13-500	203.00	Ø20.5		76.20	146.05	184.15		41.00	236.00	13.00	500.00
		A2				W203C-13-600	203.00	Ø20.5		76.20	146.05	184.15		41.00	236.00	13.00	600.00

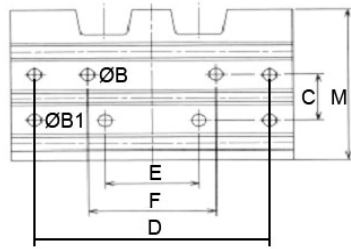

TYPE A1

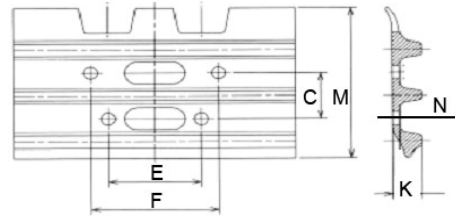

TYPE A2

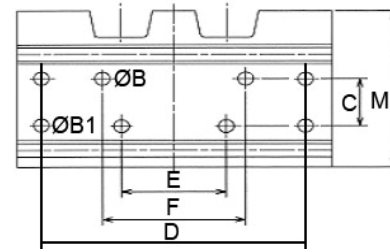

TYPE B1

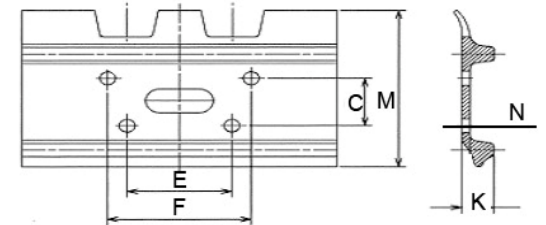

TYPE B2

No.	MACHINE MODEL	TYPE	CATERPILLA PART No.	KOMATSU PART No.	HITACHI PART No.	PART No.	DIMENSION (mm)										L
							PITCH	B	B1	C	E	F	D	K	M	N	
43	E300,EL240	A2	931948			W203D-13-600	203.00	Ø19.5		76.20	133.40	171.50		41.00	236.00	13.00	600
	229,229D	A2	9K3564			W203D-13-610	203.00	Ø19.5		76.20	133.40	171.50		41.00	236.00	13.00	610
	235LC,225SA,227,235	A2	9K3565			W203D-13-710	203.00	Ø19.5		76.20	133.40	171.50		41.00	236.00	13.00	710
	231DLC	A2	9K3568			W203D-13-915	203.00	Ø19.5		76.20	133.40	171.50		41.00	236.00	13.00	915
	231D	A2	1V0557			W203D-13-813	203.00	Ø19.5		76.20	133.40	171.50		41.00	236.00	13.00	813
44	RH9	A2				W203E-13-500	203.00	Ø19.5		76.20	116.90	155.00		41.00	236.00	13.00	500.00
		A2				W203E-13-600	203.00	Ø19.5		76.20	116.90	155.00		41.00	236.00	13.00	600.00
45	CAT977K	A2				W203F-13-500	203.00	Ø19.5		76.20	146.05	184.15		41.00	236.00	13.00	500.00
		A2				W203F-13-600	203.00	Ø19.5		76.20	146.05	184.15		41.00	236.00	13.00	600.00
		A2				W203F-13-700	203.00	Ø19.5		76.20	146.05	184.15		41.00	236.00	13.00	700.00
		A2				W203F-13-800	203.00	Ø19.5		76.20	146.05	184.15		41.00	236.00	13.00	800.00
		A2				W203F-13-900	203.00	Ø19.5		76.20	146.05	184.15		41.00	236.00	13.00	900.00
46	R944	A2				W203G-13-600	203.00	Ø19.5		76.20	148.20	186.20		41.00	236.00	13.00	600.00
47	EC330BLC,EC360	A2				W216A-11-600	216.00	Ø23.5		76.20	146.05	184.15		41.00	250.00	11.00	600.00
	330BL	A2	6Y2756			W216A-11-750	216.00	Ø23.5		76.20	146.05	184.15		41.00	250.00	11.00	750.00
	235B,235C	A2	9W6483			W216A-11-762	216.00	Ø23.5		76.20	146.05	184.15		41.00	250.00	11.00	762.00
48	PC270-7,PC290-8K,PC290-NLC,PC300-6/7, PC300-LC,PC340-6/7,PC340-NLC, EX280	A2				W216B-11-600	216.00	Ø22.5		76.20	140.40	178.40		41.00	250.00	11.00	600.00
	PC350-6, EX355, EX300-5, EX330-5, ZX270,ZX280,ZX330,ZX350,R250, R305-7,R320	A2				W216B-11-700	216.00	Ø22.5		76.20	140.40	178.40		41.00	250.00	11.00	700.00
	R290LC-7	A2				W216B-11-800	216.00	Ø22.5		76.20	140.40	178.40		41.00	250.00	11.00	800.00
		A2				W216B-11-900	216.00	Ø22.5		76.20	140.40	178.40		41.00	250.00	11.00	900.00
49	ZX330	A2				W216C-11-600	216.00	Ø22.3		76.20	140.40	178.40		41.00	250.00	11.00	600.00
		A2				W216C-11-700	216.00	Ø22.3		76.20	140.40	178.40		41.00	250.00	11.00	700.00
		A2				W216C-11-800	216.00	Ø22.3		76.20	140.40	178.40		41.00	250.00	11.00	800.00
		A2				W216C-11-900	216.00	Ø22.3		76.20	140.40	178.40		41.00	250.00	11.00	900.00
50	CAT330,330BL,330L,330LN	A2	6Y2757			W216D-11-600	216.00	Ø22.5		76.20	140.00	190.00		41.00	250.00	11.00	600.00
		A2				W216D-11-750	216.00	Ø22.5		76.20	140.00	190.00		41.00	250.00	11.00	750.00
	330BL	A2	6Y8180			W216D-11-850	216.00	Ø22.5		76.20	140.00	190.00		41.00	250.00	11.00	850.00

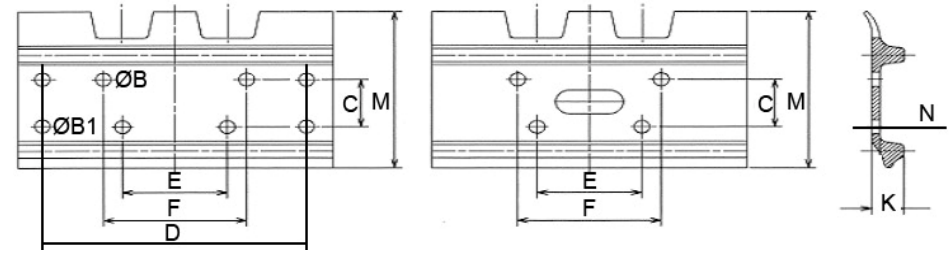
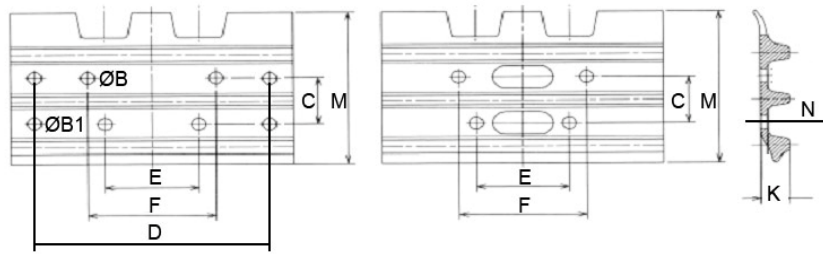

TYPE A1

TYPE A2

TYPE B1

TYPE B2

No.	MACHINE MODEL	TYPE				PART No.	DIMENSION (mm)										L
			CATERPILLA PART No.	KOMATSU PART No.	HITACHI PART No.		PITCH	B	B1	C	E	F	D	K	M	N	
51	PC400-1/3/5/6,PC410LC, 973-C/LGP,EC460	A2		208-32-51112		W216E-11-600	216.00	Ø24.5		76.20	146.00	184.00		41.00	250.00	11.00	600.00
	PC300HD-3/5,PC360LC-5	A2		208-32-51312		W216E-11-700	216.00	Ø24.5		76.20	146.00	184.00		41.00	250.00	11.00	700.00
	PC400HD-5,PC400LC-5	A2		208-32-51341		W216E-11-750	216.00	Ø24.5		76.20	146.00	184.00		41.00	250.00	11.00	750.00
	PC360LC-1/3,PC400LC	A2				W216E-11-800	216.00	Ø24.5		76.20	146.00	184.00		41.00	250.00	11.00	800.00
	R360LC-7,R450LC-7	A2				W216E-11-900	216.00	Ø24.5		76.20	146.00	184.00		41.00	250.00	11.00	900.00
52	EX300-5,PC300-6,SH330,R305	A2				W216F-11-600	216.00	Ø22.5		76.20	140.40	178.40		41.00	250.00	11.00	600.00
53	PC400-1,EX400	A2				W216G-11-600	216.00	Ø22.5		76.20	146.00	184.00		41.00	250.00	11.00	600.00
		A2				W216G-11-700	216.00	Ø22.5		76.20	146.00	184.00		41.00	250.00	11.00	700.00
		A2				W216G-11-800	216.00	Ø22.5		76.20	146.00	184.00		41.00	250.00	11.00	800.00
54	CAT235,235B,LL229	A2	3N0837			W216H-11-600	216.00	Ø19.5		76.20	146.05	184.15		41.00	250.00	11.00	600.00
55	235-83X/LC/B/C/D,345-B, E450, K914, K916, SK330, SK400, EX455, EX400-1, UH14	A2				W216A-13-600	216.00	Ø23.5		76.20	146.05	184.15		48.00	250.00	13.00	600.00
		A2	6Y2756			W216A-13-750	216.00	Ø23.5		76.20	146.05	184.15		48.00	250.00	13.00	750.00
		A2	9W6483			W216A-13-762	216.00	Ø23.5		76.20	146.05	184.15		48.00	250.00	13.00	762.00
56	R290LC-7	A2				W216B-13-600	216.00	Ø22.5		76.20	140.40	178.40		48.00	250.00	13.00	600.00
		A2				W216B-13-700	216.00	Ø22.5		76.20	140.40	178.40		48.00	250.00	13.00	700.00
		A2				W216B-13-800	216.00	Ø22.5		76.20	140.40	178.40		48.00	250.00	13.00	800.00
		A2				W216B-13-900	216.00	Ø22.5		76.20	140.40	178.40		48.00	250.00	13.00	900.00
57	ZX330	A2				W216C-13-600	216.00	Ø22.3		76.20	140.40	178.40		48.00	250.00	13.00	600.00
		A2				W216C-13-700	216.00	Ø22.3		76.20	140.40	178.40		48.00	250.00	13.00	700.00
		A2				W216C-13-800	216.00	Ø22.3		76.20	140.40	178.40		48.00	250.00	13.00	800.00
		A2				W216C-13-900	216.00	Ø22.3		76.20	140.40	178.40		48.00	250.00	13.00	900.00
58	CAT330,330BL,330L,330LN 330BL,SK350	A2	6Y2757			W216D-13-600	216.00	Ø22.5		76.20	140.00	190.00		48.00	250.00	13.00	600.00
		A2				W216D-13-750	216.00	Ø22.5		76.20	140.00	190.00		48.00	250.00	13.00	750.00
		A2	6Y8180			W216D-13-850	216.00	Ø22.5		76.20	140.00	190.00		48.00	250.00	13.00	850.00

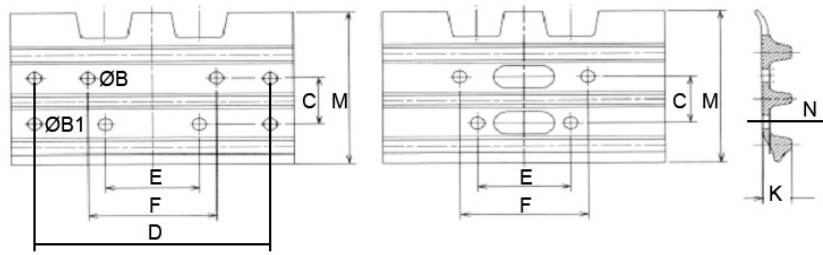

TYPE A1

TYPE A2

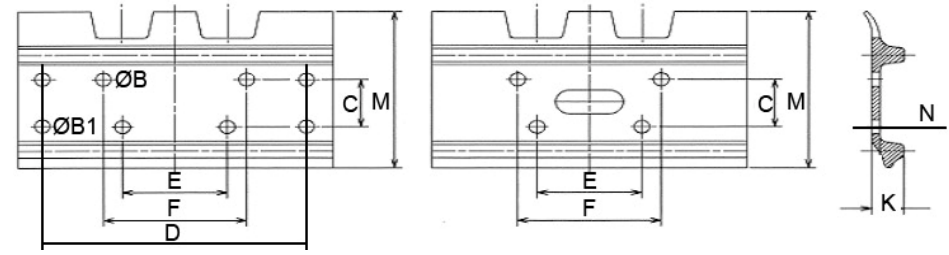

TYPE B1

TYPE B2

No.	MACHINE MODEL	TYPE	CATERPILLA PART No.	KOMATSU PART No.	HITACHI PART No.	PART No.	DIMENSION (mm)										L
							PITCH	B	B1	C	E	F	D	K	M	N	
59	SK400, EX370-5, EX400-2/3/5, EX450-5	A2		208-32-51112		W216E-13-600	216.00	Ø24.5		76.20	146.00	184.00		48.00	250.00	13.00	600.00
	R350,R360LC-7,R450LC-7,R500,EC450, EC460-B/C	A2		208-32-51312		W216E-13-700	216.00	Ø24.5		76.20	146.00	184.00		48.00	250.00	13.00	700.00
	PC400-3/5,PC400HD-5,PC400LC-5	A2		208-32-51341		W216E-13-750	216.00	Ø24.5		76.20	146.00	184.00		48.00	250.00	13.00	750.00
	PC300HD-3/5,PC360LC-1/3/5	A2				W216E-13-800	216.00	Ø24.5		76.20	146.00	184.00		48.00	250.00	13.00	800.00
	ZX370,ZX380,ZX450,ZX460,ZX470,JS460	A2				W216E-13-900	216.00	Ø24.5		76.20	146.00	184.00		48.00	250.00	13.00	900.00
60	EX300-5,PC300-6,SH330	A2				W216F-13-600	216.00	Ø22.5		76.20	140.40	178.40		48.00	250.00	13.00	600.00
61	PC400-1,EX400	A2				W216G-13-600	216.00	Ø22.5		76.20	146.00	184.00		48.00	250.00	13.00	600.00
		A2				W216G-13-700	216.00	Ø22.5		76.20	146.00	184.00		48.00	250.00	13.00	700.00
		A2				W216G-13-800	216.00	Ø22.5		76.20	146.00	184.00		48.00	250.00	13.00	800.00
62	CAT235,235B,LL229	A2	3N0837			W216H-13-800	216.00	Ø19.5		76.20	146.05	184.15		48.00	250.00	13.00	600.00
63	PC380-LC,PC400-3/5/6/7,PC400-LC, PC450-6/7,PC450-LC SK450, SK460, SK480, SK485, E485					W228A-17-600	228.00	Ø24.5		76.20	144.00	184.00		57.00	258.00	17.00	600.00
						W228B-15.5-600	228.00	Ø24.4		76.20	149.20	200.00		37.00	254.00	15.50	600.00

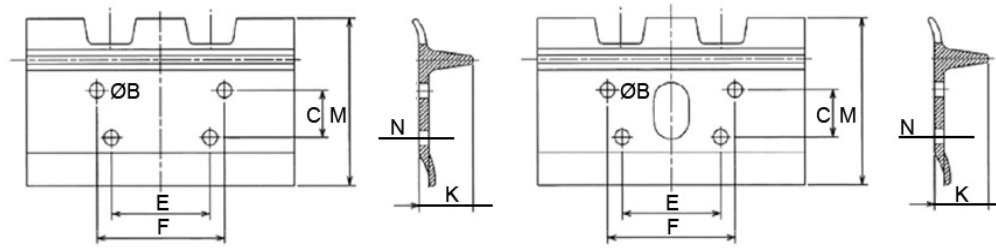

A1

A2

No.	MACHINE MODEL	TYPE	CATERPILLA PART No.	KOMATSU PART No.		PART No.	DIMENSION (mm)									L	
							PITCH	B		C	E	F		K	M		N
1	D31	A1				T154A-10-420	154.00	14.50		58.70	82.40	112.50		57.00	182.50	10.00	420.00
2	D4, D4-C, D4-D/E, D5-C,941,941B	A1	5K8566		4K7052	T171A-12-330	171.00	Ø14.8		60.30	107.90	107.90		62.00	199.60	12.00	330.00
	D4D,D4D-SA,D4E-SA,D4	A1	4K7175			T171A-12-406	171.00	Ø14.8		60.30	107.90	107.90		62.00	199.60	12.00	406.00
	D4C	A1	4K7188			T171A-12-457	171.00	Ø14.8		60.30	107.90	107.90		62.00	199.60	12.00	457.00
	D4D-LGP,D4D	A1	5K4355			T171A-12-762	171.00	Ø14.8		60.30	107.90	107.90		62.00	199.60	12.00	762.00
3	D4H-XL,D5C-LGP,D5M-XL	A1				T171B-12-508	171.00	Ø17		57.00	103.80	144.00		62.00	199.60	12.00	508.00
		A1				T171B-12-559	171.00	Ø17		57.00	103.80	144.00		62.00	199.60	12.00	559.00
	D4H-TSK,D5C,561H,D4H	A1				T171B-12-660	171.00	Ø17		57.00	103.80	144.00		62.00	199.60	12.00	660.00
	939,D4H-TSK	A1	3T0360			T171B-12-457	171.00	Ø17		57.00	103.80	144.00		62.00	199.60	12.00	457.00
	D4H-LGP,D5M-LGP	A1	3T6163			T171B-12-762	171.00	Ø17		57.00	103.80	144.00		62.00	199.60	12.00	762.00
4	D4E,D4E-5R,D4E-SA,D4	A1	1V4626			T171C-12-406	171.00	Ø16.5		60.30	107.90	107.90		62.00	199.60	12.00	406.00
	D4D,D4D-SA,D4E-SA,D4	A1	1V4630			T171C-12-330	171.00	Ø16.5		60.30	107.90	107.90		62.00	199.60	12.00	330.00
	D4E-LGP	A1	8K2276			T171C-12-762	171.00	Ø16.5		60.30	107.90	107.90		62.00	199.60	12.00	762.00
5	D5B-LGP,D5-LGP	A1	7S9567			T171D-12-864	171.00	Ø16.5		58.75	125.40	144.50		62.00	199.60	12.00	864.00
	D6,D6B,D5,D5B,D6	A1	5S0820			T171D-12-406	171.00	Ø16.5		58.75	125.40	144.50		62.00	199.60	12.00	406.00
	D5E,D5-SA,561C,561D,D5-LGP, D5-SA,D5B,D5B-SA	A1	5S0821			T171D-12-457	171.00	Ø16.5		58.75	125.40	144.50		62.00	199.60	12.00	457.00
6	D4E,D4E-5R,D4E-SA	A1	1V4626			T171E-12-406	171.00	Ø16.5		38.10	104.77	109.93		62.00	199.60	12.00	406.00
	D4E	A1	1V4630			T171E-12-330	171.00	Ø16.5		38.10	104.77	109.93		62.00	199.60	12.00	330.00
	D4D-LGP,D4E-LGP	A1	8K2276			T171E-12-762	171.00	Ø16.5		38.10	104.77	109.93		62.00	199.60	12.00	762.00
7	D40A,D40F,D41E,D45A,D45E	A1		130-32-11113		T171F-12-400	171.00	Ø16.5		57.00	122.40	158.40		62.00	199.60	12.00	400.00
	D41P,D45P	A1		12G-32-11110		T171F-12-710	171.00	Ø16.5		57.00	122.40	158.40		62.00	199.60	12.00	710.00
	D50A,D50F,D53A,D58E	A1		130-32-11291		T171F-12-406	171.00	Ø16.5		57.00	122.40	158.40		62.00	199.60	12.00	460.00
	D50P,D50PL,D53P,D53P,D58P	A1		13F-32-21210		T171F-12-860	171.00	Ø16.5		57.00	122.40	158.40		62.00	199.60	12.00	860.00
	D58P	A1		130-32-11381		T171F-12-560	171.00	Ø16.5		57.00	122.40	158.40		62.00	199.60	12.00	560.00
	D63E	A1		130-32-11270		T171F-12-510	171.00	Ø16.5		57.00	122.40	158.40		62.00	199.60	12.00	510.00
	D41S,D45S,D50S,D53S	A2		131-32-11316		T171F-12-400	171.00	Ø16.5		57.00	122.40	158.40		62.00	199.60	12.00	400.00
8	D4	A2				T171G-12-450	171.00	Ø16.5		60.30	107.90	107.90		62.00	199.60	12.00	450.00
9	DC100,D39-EX,D39-PX,D41-E/P, D4-H, 5D-C/G/M/N	A2				T171H-12-500	171.00	Ø16.5		57.00	103.80	144.00		62.00	199.60	12.00	500.00
		A2				T171H-12-510	171.00	Ø16.5		57.00	103.80	144.00		62.00	199.60	12.00	510.00

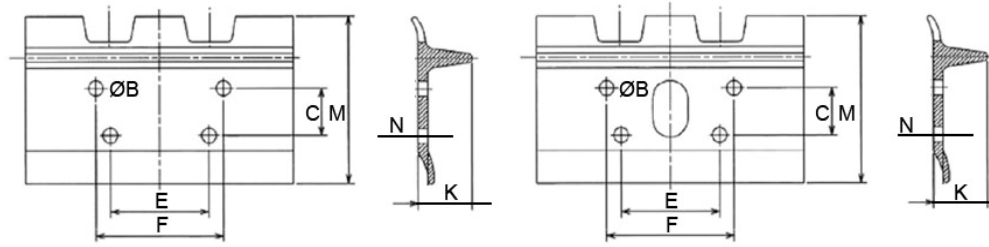

No.	MACHINE MODEL	TYPE	A1		A2		DIMENSION (mm)								L	
			CATERPILLA PART No.	KOMATSU PART No.	PART No.	PITCH	B	C	E	F	K	M	N			
10	D60AS,D65S,D66S	A1		141-32-11292	T203A-12-460	203.00	Ø19.5		72.10	138.30	178.30		77.00	232.50	12.00	460.00
	D60A,D60E,D65A,D65E,D75A	A1		144-32-11112	T203A-12-510	203.00	Ø19.5		72.10	138.30	178.30		77.00	232.50	12.00	510.00
	D60F	A1		144-32-11341	T203A-12-560	203.00	Ø19.5		72.10	138.30	178.30		77.00	232.50	12.00	560.00
	D68E	A1		144-32-11361	T203A-12-660	203.00	Ø19.5		72.10	138.30	178.30		77.00	232.50	12.00	660.00
	D65P,D68P	A1		14G-32-E1280	T203A-12-950	203.00	Ø19.5		72.10	138.30	178.30		77.00	232.50	12.00	950.00
11	D65-E,D65-EX,D65-PX,D70-LE TY160,YISHAN160,D65E,D85E	A1		14X-32-11110	T203B-12-510	203.00	Ø20.5		72.10	138.30	178.30		77.00	232.50	12.00	510.00
12	D6D-LGP	A1	1P2062		T203C-12-915	203.00	Ø19.5		76.20	133.30	171.30		77.00	232.50	12.00	915.00
	D6D,D6D-DD,D6D-PS,D6C	A1	6Y6289		T203C-12-457	203.00	Ø19.5		76.20	133.30	171.30		77.00	232.50	12.00	457.00
	D6D,D6D-DD,D6C-SA,D6D,PS,D6E,D6G 955L	A1	7S9557	7S9565	T203C-12-508	203.00	Ø19.5		76.20	133.30	171.30		77.00	232.50	12.00	508.00
	963,963-LGP	A1	1V9470		T203C-12-432	203.00	Ø19.5		76.20	133.30	171.30		77.00	232.50	12.00	432.00
	963-LGP	A1	8E4494		T203C-12-457	203.00	Ø19.5		76.20	133.30	171.30		77.00	232.50	12.00	457.00
	963-LGP	A1	7P2493		T203C-12-559	203.00	Ø19.5		76.20	133.30	171.30		77.00	232.50	12.00	559.00
13	D7G,572C,572D	A1	1S7179		T203D-12-610	203.00	Ø20.5		76.20	146.00	184.00		77.00	232.50	12.00	610.00
	D7	A1	1S7178		T203D-12-457	203.00	Ø20.5		76.20	146.00	184.00		77.00	232.50	12.00	457.00
	D7,D7D,D7C	A1	7M0732		T203D-12-508	203.00	Ø20.5		76.20	146.00	184.00		77.00	232.50	12.00	508.00
	977E,977K,977L,977H	A2	9S4783		T203D-12-457	203.00	Ø20.5		76.20	146.00	184.00		77.00	232.50	12.00	457.00
	YISHAN 120	A2			T203D-12-500	203.00	Ø20.5		76.20	146.00	184.00		77.00	232.50	12.00	500.00
14	D7,PD120,T120	A2			T203E-12-500	203.00	Ø20.5		72.00	146.00	184.00		77.00	232.50	12.00	500.00
		A2			T203E-12-620	203.00	Ø20.5		72.00	146.00	184.00		77.00	232.50	12.00	620.00
		A2			T203E-12-650	203.00	Ø20.5		72.00	146.00	184.00		77.00	232.50	12.00	650.00
15	D6H,D6H-DD,527,D6R,D6H-XR	A1	6Y6286		T203F-12-510	203.00	Ø20.5		68.00	137.30	185.30		77.00	232.50	12.00	510.00
	D6H-XL,D6R-XL	A1	9G9096		T203F-12-559	203.00	Ø20.5		68.00	137.30	185.30		77.00	232.50	12.00	559.00
	D6H-LGP,D6R-LGP,D6H-LGP	A1	9G9580		T203F-12-914	203.00	Ø20.5		68.00	137.30	185.30		77.00	232.50	12.00	914.00
16	D6D-LGP	A1	1P2062		T203G-12-915	203.00	Ø19.5		44.40	134.10	158.75		77.00	232.50	12.00	915.00
	D6D,D6D-DD,D6D-PS,D6C,D6C-DD, 963,963-LGP	A1	6Y6289	8E4494	T203G-12-457	203.00	Ø19.5		44.40	134.10	158.75		77.00	232.50	12.00	457.00
	D6D,D6D-DD,D6E,D6G	A1	7S9557	7S9565	T203G-12-508	203.00	Ø19.5		44.40	134.10	158.75		77.00	232.50	12.00	508.00
	955L	A1	1V9470		T203G-12-432	203.00	Ø19.5		44.40	134.10	158.75		77.00	232.50	12.00	432.00
	963-LGP	A1	7P2493		T203G-12-559	203.00	Ø19.5		44.40	134.10	158.75		77.00	232.50	12.00	559.00

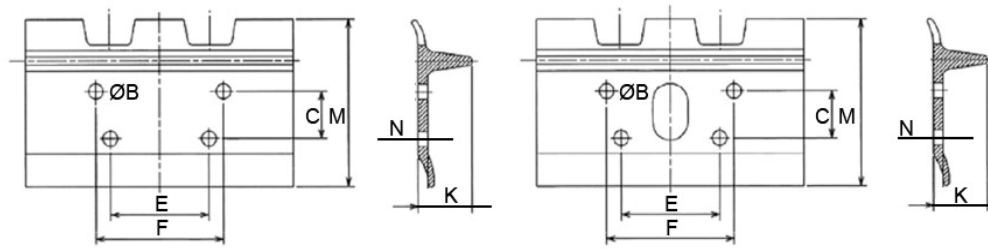

A1

A2

No.	MACHINE MODEL	TYPE	CATERPILLA PART No.	KOMATSU PART No.	PART No.	DIMENSION (mm)									L
						PITCH	B	C	E	F	K	M	N		
17	D8	A1	7H4736		T203H-12-457	203.00	Ø19.5	76.20	168.27	209.55	77.00	232.50	12.00	457.00	
	583C,583E	A1	7H4738		T203H-12-762	203.00	Ø19.5	76.20	168.27	209.55	77.00	232.50	12.00	762.00	
	D8D,D8E,D8F,D8G	A1	7H4750		T203H-12-508	203.00	Ø19.5	76.20	168.27	209.55	77.00	232.50	12.00	508.00	
18		A1			T203K-12-560	203.00	Ø20.5	72.00	137.30	185.30	77.00	232.50	12.00	560.00	
		A1			T203K-12-610	203.00	Ø20.5	72.00	137.30	185.30	77.00	232.50	12.00	610.00	
19	572E,572F,572G	A1	1S7179		T216A-14-610	216.00	Ø19.5	76.20	146.00	184.00	86.30	252.25	14.00	610.00	
	D7F,571A,571F,571G,D7G-SA	A1	7M0730		T216A-14-559	216.00	Ø19.5	76.20	146.00	184.00	86.30	252.25	14.00	559.00	
	D7E,D7F,D7G	A1	7M0732		T216A-14-508	216.00	Ø19.5	76.20	146.00	184.00	86.30	252.25	14.00	508.00	
	D7G-LGP	A1	8P0430		T216A-14-864	216.00	Ø19.5	76.20	146.00	184.00	86.30	252.25	14.00	864.00	
20	D80-A/E/F/P,D85-A/E/P,D5H	A1		154-32-11113	T216B-14-560	216.00	Ø20.5	76.20	146.00	184.00	86.30	252.25	14.00	560.00	
	D83E	A1		154-32-11315	T216B-14-610	216.00	Ø20.5	76.20	146.00	184.00	86.30	252.25	14.00	610.00	
	D80P,D83P,D85P	A1		154-820-1310	T216B-14-910	216.00	Ø20.5	76.20	146.00	184.00	86.30	252.25	14.00	910.00	
	D75S	A1		145-32-11311	T216B-14-480	216.00	Ø20.5	76.20	146.00	184.00	86.30	252.25	14.00	480.00	
	D75S	A1		145-32-11313	T216B-14-460	216.00	Ø20.5	76.20	146.00	184.00	86.30	252.25	14.00	460.00	
	D95S	A1		154-32-11412	T216B-14-510	216.00	Ø20.5	76.20	146.00	184.00	86.30	252.25	14.00	510.00	
21	572F,572G	A1	1S7179		T216C-14-610	216.00	Ø20.5	76.20	146.00	172.00	86.30	252.25	14.00	610.00	
	571F,571G,D7G,D7G-SA	A1	7M0730		T216C-14-559	216.00	Ø20.5	76.20	146.00	172.00	86.30	252.25	14.00	559.00	
	D7G,D7G-DD,D7G-PS	A1	7M0732		T216C-14-508	216.00	Ø20.5	76.20	146.00	172.00	86.30	252.25	14.00	508.00	
	D7G-LGP	A1	8P0430		T216C-14-864	216.00	Ø20.5	76.20	146.00	172.00	86.30	252.25	14.00	864.00	
22	D7H-LGP	A1	3T6210		T216D-14-914	216.00	Ø20.5	70.00	149.50	205.50	86.30	252.25	14.00	914.00	
	D7H,D7H-XR	A1	9G2434		T216D-14-559	216.00	Ø20.5	70.00	149.50	205.50	86.30	252.25	14.00	559.00	
	D7H	A1	9G2430		T216D-14-508	216.00	Ø20.5	70.00	149.50	205.50	86.30	252.25	14.00	508.00	
23	D7H, D7R,D8L,D8ND7H-XR	A1	7T0737		T216E-14-559	216.00	Ø23.5	63.00	146.10	204.10	86.30	252.25	14.00	559.00	
	D7H-LGP,D8L-SA	A1	7T2310		T216E-14-914	216.00	Ø23.5	63.00	146.10	204.10	86.30	252.25	14.00	914.00	
24	TD20	A2			T216F-14-610	216.00	Ø19.5	74.62	154.90	199.39	86.30	252.25	14.00	610.00	
25		A2			T216G-14-500	216.00	Ø19.5	76.20	146.00	184.00	86.30	252.25	14.00	500.00	
		A2			T216G-14-610	216.00	Ø19.5	76.20	146.00	184.00	86.30	252.25	14.00	610.00	
		A2			T216G-14-620	216.00	Ø19.5	76.20	146.00	184.00	86.30	252.25	14.00	620.00	
26		A2			T216M-14-560	216.00	Ø20.5	50.80	147.00	172.40	86.30	252.25	14.00	560.00	
27		A2			T216N-14-560	216.00	Ø19.5	63.00	146.10	204.10	86.30	252.25	14.00	560.00	

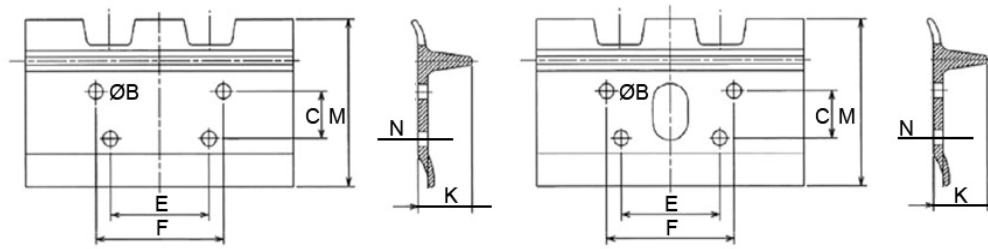

A1

A2

No.	MACHINE MODEL	TYPE	CATERPILLA PART No.	KOMATSU PART No.	PART No.	DIMENSION (mm)									L
						PITCH	B	C	E	F	K	M	N		
28	D135A,D155A,D155AX,D135,D150	A1		170-32-11115	T228A-17-560	228.00	Ø24.5	76.20	169.00	219.80	97.00	263.00	17.00	560.00	
	D155C	A1		175-32-11132	T228A-17-710	228.00	Ø24.5	76.20	169.00	219.80	97.00	263.00	17.00	710.00	
	D155	A2		178-32-11290	T228A-17-560	228.00	Ø24.5	76.20	169.00	219.80	97.00	263.00	17.00	560.00	
	D155S	A2			T288A-17-610	228.00	Ø24.5	76.20	169.00	219.80	97.00	263.00	17.00	610.00	
29	D8-H/K, 583H/K	A1	7S9093		T228B-17-559	228.00	Ø23.8	76.20	169.30	201.10	97.00	263.00	17.00	559.00	
		A1	7S9098		T228B-17-711	228.00	Ø23.8	76.20	169.30	201.10	97.00	263.00	17.00	711.00	
30	D8-H/K, 583H,583K	A1	7S9093		T228C-17-559	228.00	Ø23.5	50.80	179.10	201.10	97.00	263.00	17.00	559.00	
		A1	7S9098		T228C-17-711	228.00	Ø23.5	50.80	179.10	201.10	97.00	263.00	17.00	711.00	
31	D9L	A1	3T2758		T228D-17-610	228.00	Ø26	63.50	169.00	235.00	97.00	263.00	17.00	610.00	
	589	A1	3T5756		T228D-17-813	228.00	Ø26	63.50	169.00	235.00	97.00	263.00	17.00	813.00	